

# Linear actuator

CAHM-65

## Benefits

- Modular
- Robust
- Reliable
- High speed and/or high load
- All metal design



Picture CAHM-6520-BN0600-A4-R00



Dimensional drawing

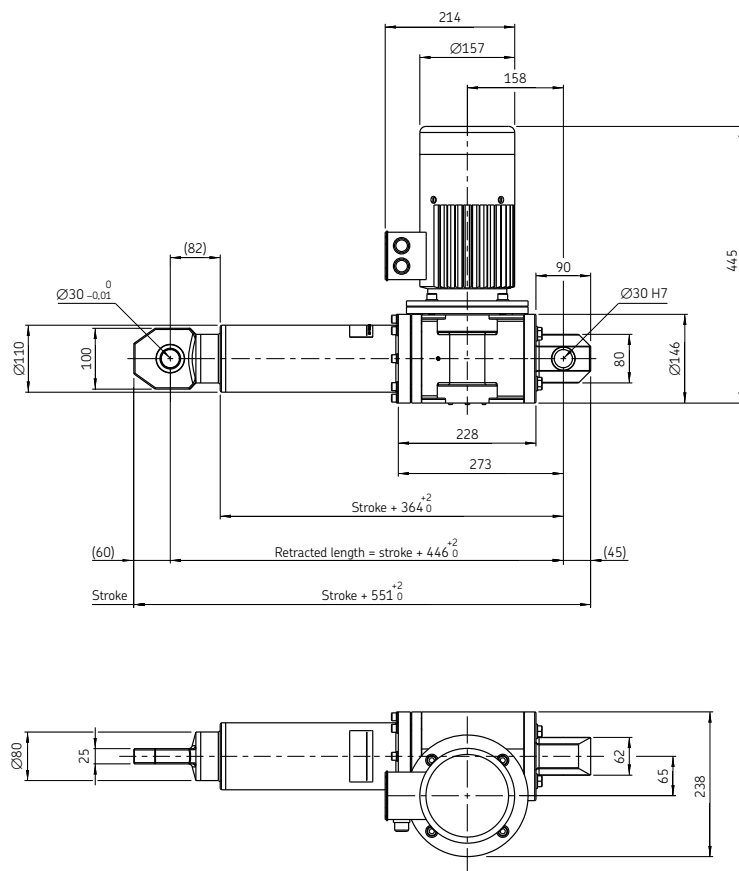

Technical data

	Unit	CAHM-6506	CAHM-6513	CAHM-6520	CAHM-6550
Rated push load	N	18 000	34 000	50 000	50 000
Rated pull load	N	18 000	34 000	50 000	50 000
Speed (at full load)	mm/s	74	36	23	9
Stroke	mm	100 to 700	100 to 700	100 to 700	100 to 700
Retracted length	mm	S+446	S+446	S+446	S+446
Voltage	VAC	3x400	3x400	3x400	3x400
Power consumption	W	3 000	3 000	3 000	1 900
Current consumption	A	3,9	3,9	3,9	3,6
Duty cycle	%	10 (1/9)	10 (1/9)	10 (1/9)	10 (1/9)
Ambient temperature	°C	-10 to +40	-10 to +40	-10 to +40	-10 to +40
Type of protection	IP	54	54	54	54
Weight	kg	40	40	40	40
Color	-	Silver	Silver	Silver	Silver

Connecting diagrams

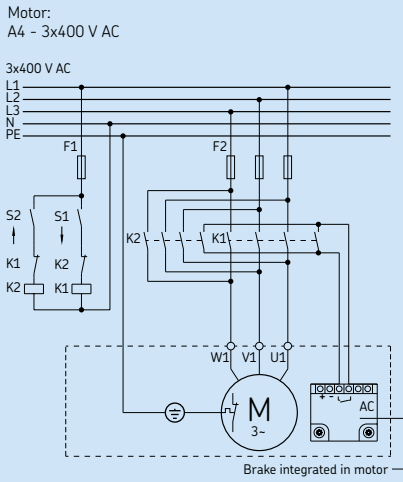

Performance diagram

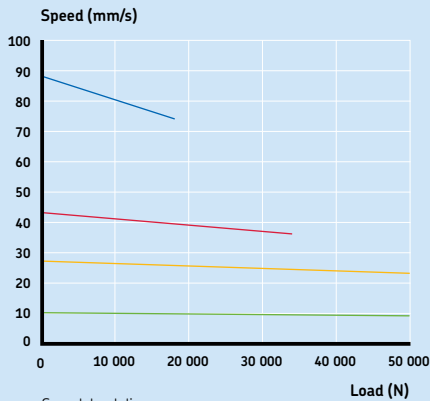

- CAHM-6506
- CAHM-6513
- CAHM-6520
- CAHM-6550

Safety factor load conditions

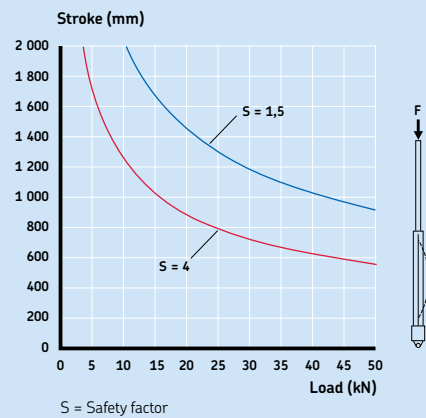

Ordering key

Load [N] / Full Load Speed [mm/s]			
18 000 / 74	34 000 / 36	50 000 / 23	50 000 / 9
6	13	20	50

C A H M - 6 5 - B N 0 - A 4 - R 0 0 - 0 0 0

Type

Size (Gear Center Distance)

65 mm

6 5

Gear Ratio

6  
13  
20  
50

0 6  
1 3  
2 0  
5 0

Screw Type

Ball screw 50x10

B N

Stroke

100 mm  
200 mm  
300 mm  
400 mm  
500 mm  
600 mm  
700 mm

0 1 0 0  
0 2 0 0  
0 3 0 0  
0 4 0 0  
0 5 0 0  
0 6 0 0  
0 7 0 0

Motor

3x400 VAC

A 4

Front Attachment

Rod End

R

Option 1 - Brake

No option - Brake is in the motor as standard

0

Option 2

No option

0

Customer option

0 0 0

